

BIRCOparksafe®
concrete – asphalt: cl. A 15 – C 250

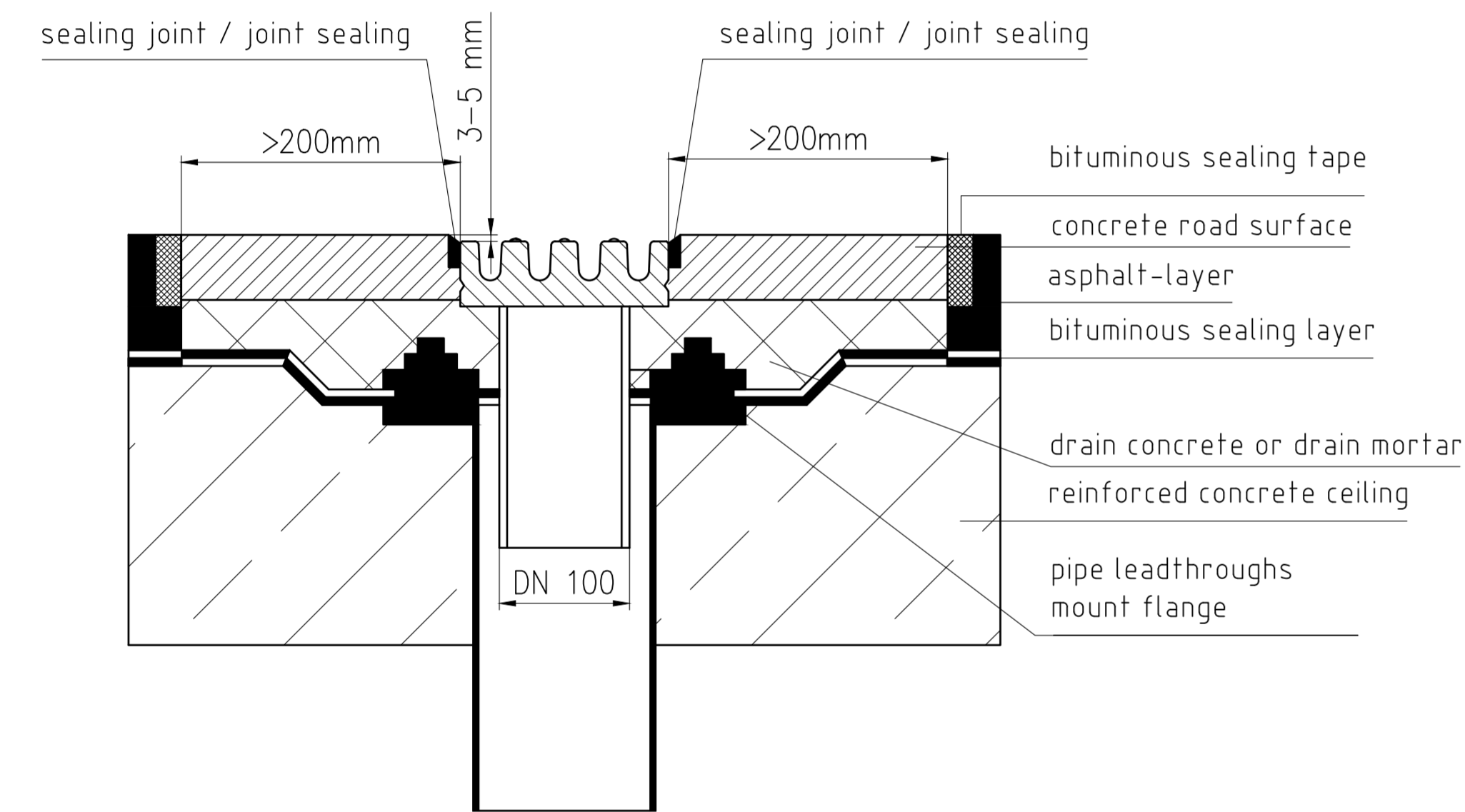

BIRCOparksafe®
concrete – melted asphalt: Kl. A 15 – C 250

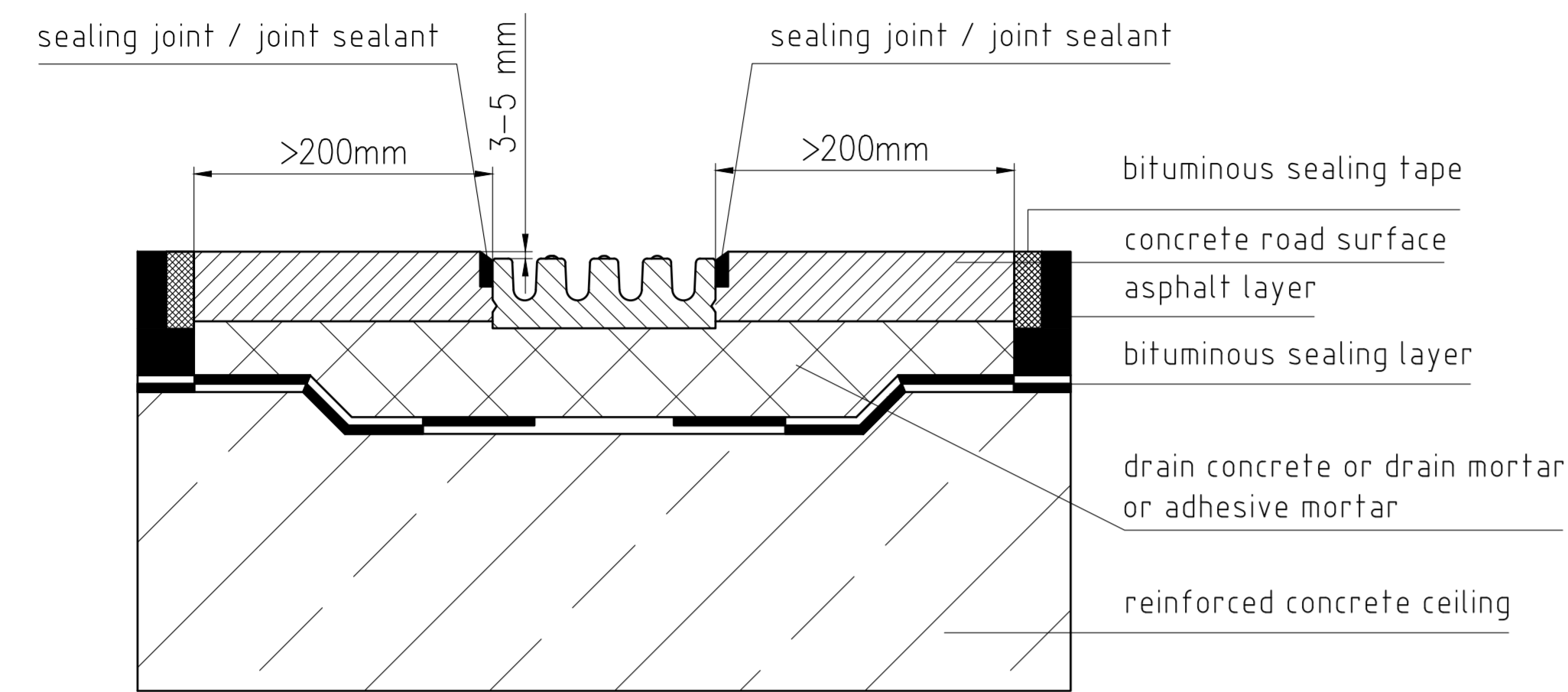
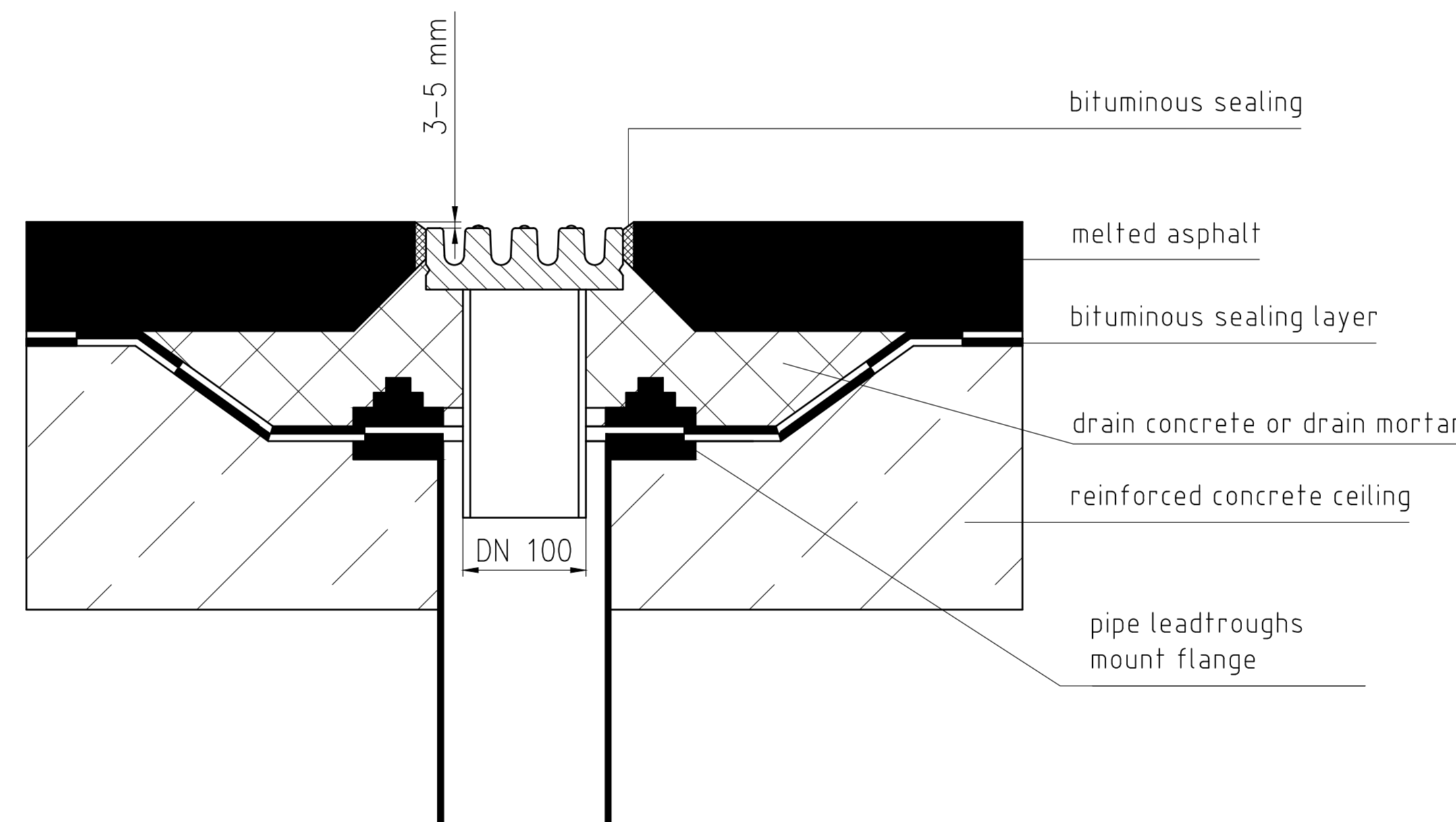
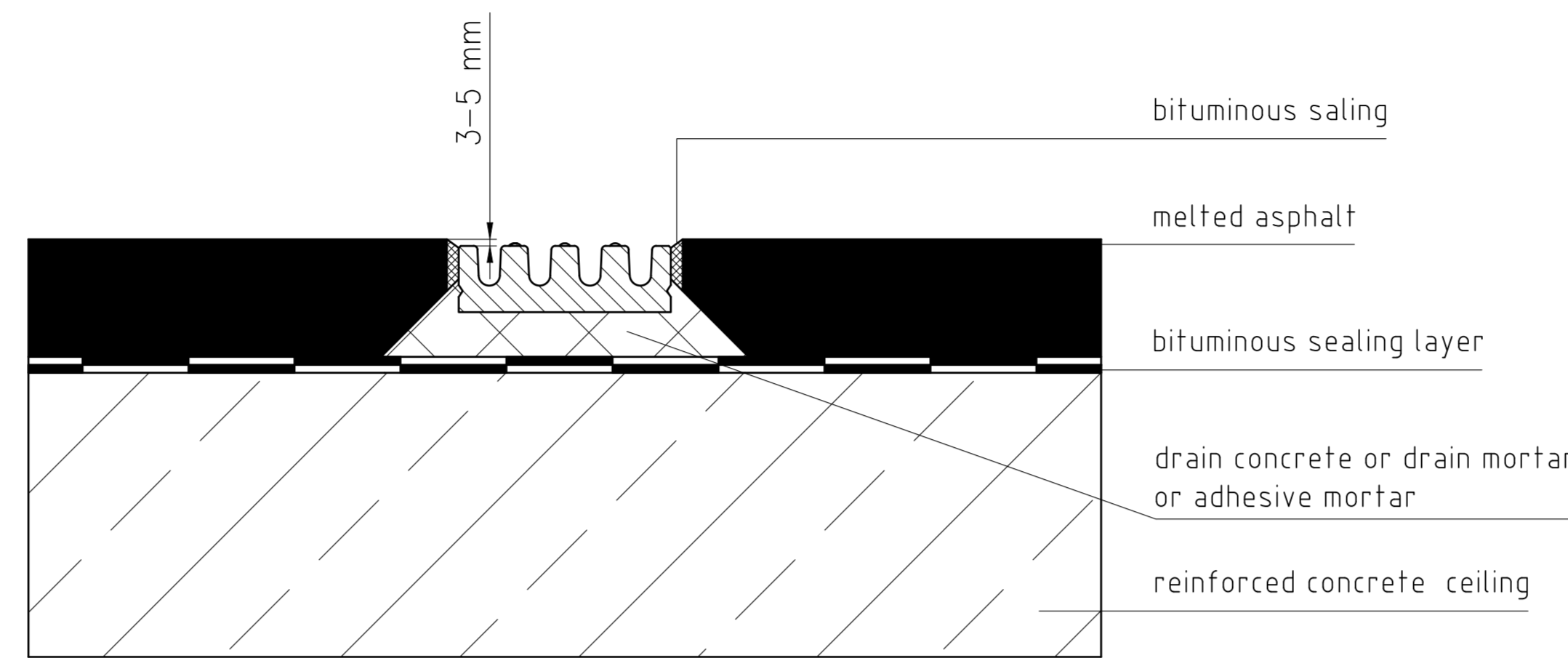

BIRCOparksafe®
concrete: Kl. A 15 – C 250

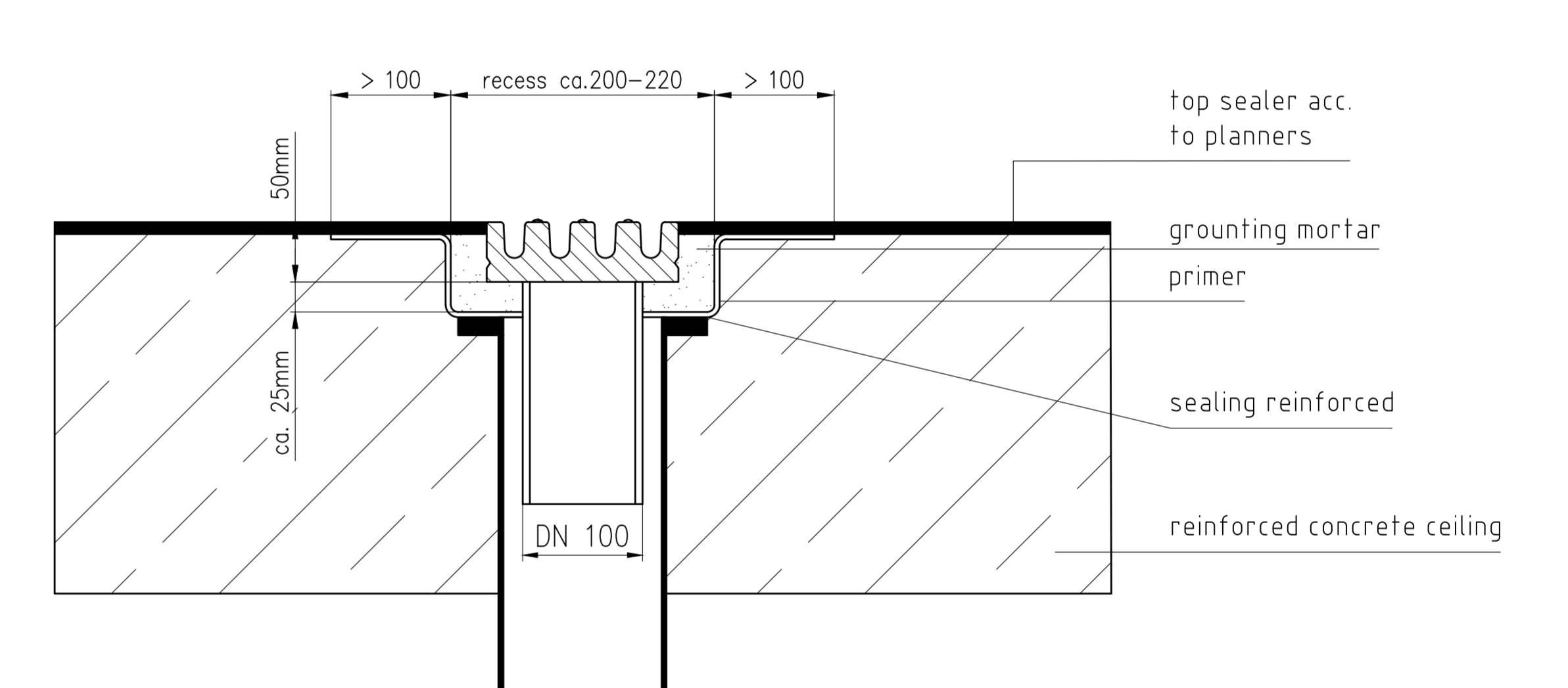
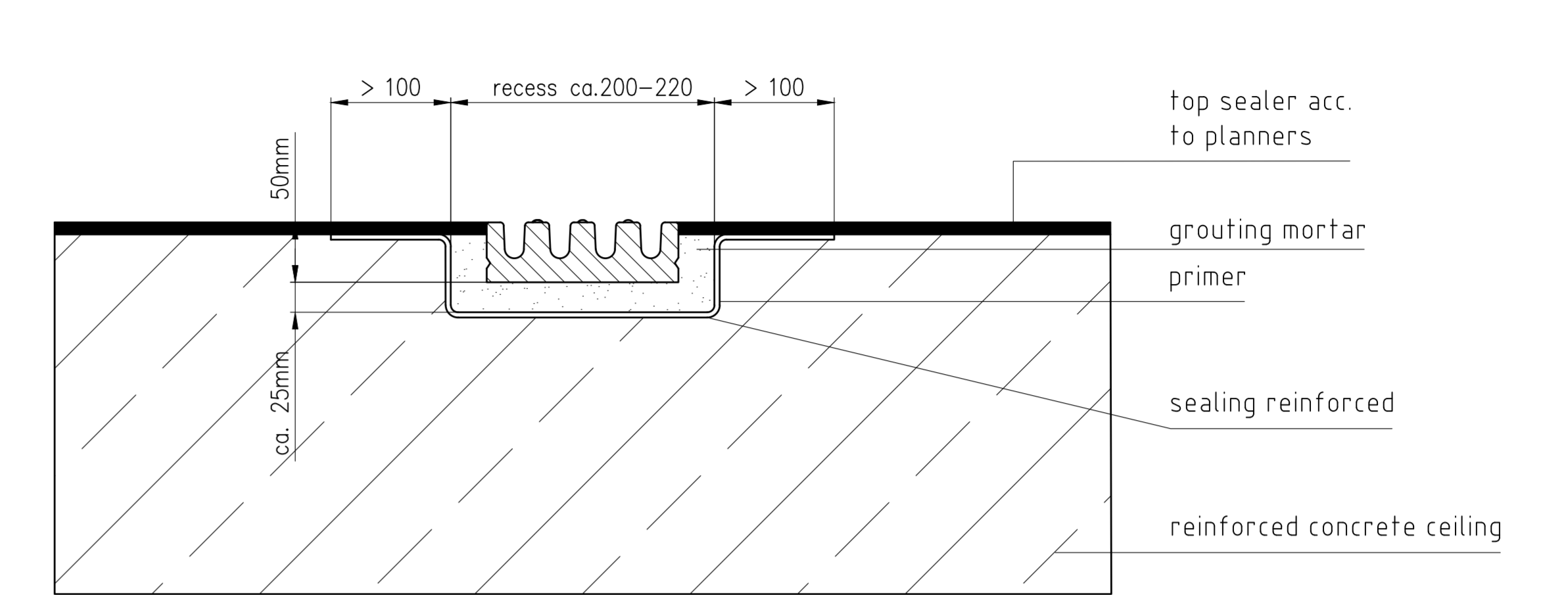

When pavement surfaces are being laid and pressed, it must be ensured that the pavement material is not forced against the channel

Jointing Information

Sealing of the channel joint / safety seam with SF-Connect after the laying of the drainage channels.

Areas of application: Adhesion of concrete, clinker, steel, stainless steel, aluminium, polyester (GFK), PVC, acrylic, polystyrene, glass, wood.

Properties:

Coated bases must be inspected in advance for adhesion and compatibility. The hardening period depends on the temperature and moisture. Higher temperatures reduce the drying period time. SF-Connect does not contain solvents, isocyanate or silicones and does not require special warning labelling. Prior to beginning the work, it is necessary to make oneself familiar with the handling and safety instructions by reading the material safety data sheet.

Working Instructions:

1. Use the industrial grouting pistol (item code 608500) to apply the sealant to the channel joint / safety seam.
2. Prior to applying the sealant to the safety joint, clean the channel end / safety seam and remove separating agents, dust, soiling, oil and other residues that could inhibit adhesion.
3. Wear protective gloves and eyewear when conducting the work.
4. Insert tubular bag (600 ml) into the industrial grouting gun.
5. Inject SF-Connect into joint.
6. Then smooth out the channel joint / safety seam surface with a jointer or putty knife that has been dipped in a soap solution.
7. Allow material residue to dry. Dried residue can be disposed of as residual waste.

Pos.	kommt vor	Änder. Nr.	Änderung				Datum	Name/gepr.
Allgemeintoleranz	Maß	bis 6	>6-30	>30-120	>120-400	>400-1000		
DIN 7168 m	Tol.	±0,1	±0,2	±0,3	±0,5	±0,8		
Werksstückkanten n. DIN ISO 137 15			Oberflächenzeichen nach ISO 1302					
Vertraulichkeit dieser Unterlage ist zu wahren. Schutzvermerk DIN 34 beachten.								
BIRCO			BIRCO GmbH Herrenpödel 142 76532 Baden-Baden			Objekt-Nr.: Kunden-Nr.:		
gez.	Datum	Name	Installation instructions			BIRCOparksafe®		
gepr.	09.07.2024	FS	Klasse A 15 – C 250			Zeichn. Nr.		
Maßstab:	1:4		Zeichn. Nr.			JVAWT/Embau/EN1433/parksafe/25843_ENG		
CAD	A 1.0							