

# BIRCOslotted steel covers | for NW 100

Material thickness 4 mm – hot-dipped galvanised 70 µm

**Slotted steel covers | symmetrical | material thickness 4 mm**

- + Hot-dipped galvanised 70 µm
- + Also available in stainless steel (V2A)
- + For channel elements NW 100
- + Connection height 140, total height 144

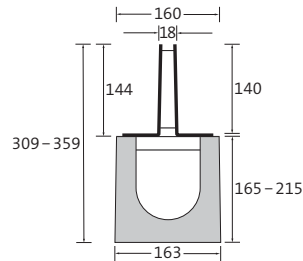

Description	Length	Width	Construction height	Weight	Inlet opening	Inlet cross section	Load class DIN EN 1433	Article no.
hot-dipped galvanised	500 mm	160 mm	144 mm	6.6 kg	SW 18 mm	180 cm <sup>2</sup> /m	A 15 – E 600	083182
hot-dipped galvanised	1000 mm	160 mm	144 mm	13.0 kg	SW 18 mm	180 cm <sup>2</sup> /m	A 15 – E 600	083181

**Slotted steel covers | asymmetrical | material thickness 4 mm**

- + Hot-dipped galvanised 70 µm
- + Also available in stainless steel (V2A)
- + For channel elements NW 100
- + Connection height 104, total height 144

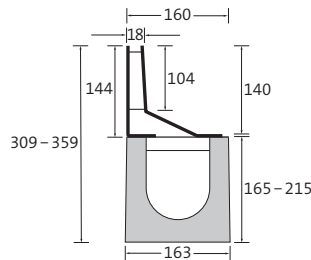

Description	Length	Width	Construction height	Weight	Inlet opening	Inlet cross section	Load class DIN EN 1433	Article no.
hot-dipped galvanised	500 mm	160 mm	144 mm	6.9 kg	SW 18 mm	180 cm <sup>2</sup> /m	A 15 – E 600	083184
hot-dipped galvanised	1000 mm	160 mm	144 mm	13.7 kg	SW 18 mm	180 cm <sup>2</sup> /m	A 15 – E 600	083183

**Access covers | 2-piece | material thickness 4 mm**

- + Hot-dipped galvanised 70 µm
- + Also available in stainless steel (V2A)
- + For channel elements/outfall units NW 100
- + For total height 144
- + With removable insert as maintenance and cleaning opening

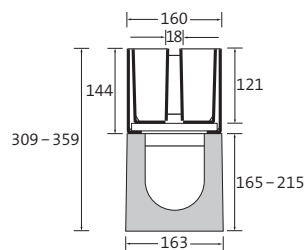

Description	Length	Width	Construction height	Weight	Inlet opening	Inlet cross section	Load class DIN EN 1433	Article no.
without slot	500 mm	160 mm	144 mm	14.0 kg	-	-	A 15 – E 600	083158
symmetrical slot	500 mm	160 mm	144 mm	16.9 kg	SW 18 mm	180 cm <sup>2</sup> /m	A 15 – E 600	083159
asymmetrical slot	500 mm	160 mm	144 mm	13.4 kg	SW 18 mm	180 cm <sup>2</sup> /m	A 15 – E 600	083160

SW = slot width  
Other connection heights on request.



### Channel elements NW 100 for slotted steel covers/access covers | without internal inbuilt fall

- + Covered concrete edge by slotted steel cover/access cover
- + Safety sealing joint
- + Channel elements with internal inbuilt fall upon request

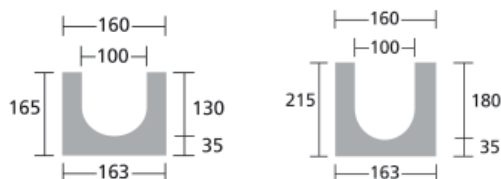

Description	Length	Width	Construction height at groove/tongue	Weight	Load class DIN EN 1433	Article no.
No. 0/0	500 mm	160 mm	165/165 mm	19.0 kg	A 15 – E 600	083331
No. 0/0	1000 mm	160 mm	165/165 mm	37.0 kg	A 15 – E 600	083326
No. 5/0	1000 mm	160 mm	190/190 mm	41.0 kg	A 15 – E 600	083327
No. 10/0	1000 mm	160 mm	215/215 mm	44.0 kg	A 15 – E 600	083328

### Outfall unit NW 100 for access covers | 1-piece

- + 1- or 2-sided channel connection to no. 10/0
- + PP silt bucket
- + PP odour trap
- + Integrated sockets for DN 100 pipe connection

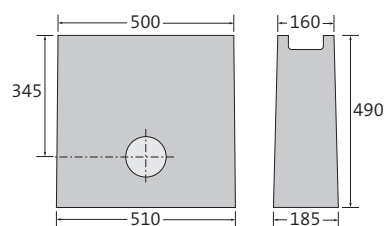

Description	Length	Width at top/ at ground	Construction height	Weight	Load class DIN EN 1433	Article no.
until no. 10	500 mm	160/185 mm	490 mm	57.0 kg	A 15 – E 600	083335

### Lifting device for access covers | Set



Description	Weight	Article no.
Lifting device for all access covers without slot	0.4 kg	083190
Lifting device for all access covers with slot (symmetrical or asymmetrical)	0.4 kg	083191

### End caps

Description	Width	For construction height	Weight	Article no.
End cap, galvanised, no. 0/0-4	160 mm	155-175 mm	0.3 kg	083195
End cap, galvanised, no. 5-8	160 mm	175-195 mm	0.3 kg	083196
End cap, galvanised, no. 9-12	160 mm	195-215 mm	0.4 kg	083197

# BIRCOslotted steel covers | for NW 100

Material thickness 1.5 mm

**Slotted steel covers | symmetrical | material thickness 1.5 mm**

- + Galvanised
- + Also available in stainless steel (V2A)
- + For channel elements NW 100
- + Connection height 120, total height 121.5

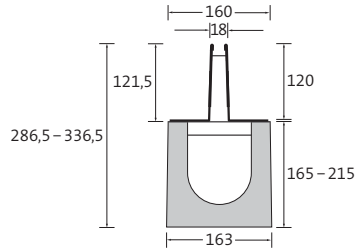

Description	Length	Width	Construction height	Weight	Inlet opening	Inlet cross section	Load class DIN EN 1433	Article no.
galvanised	500 mm	160 mm	121.5 mm	2.6 kg	SW 18 mm	180 cm <sup>2</sup> /m	A 15 – C 250	083164
galvanised	1000 mm	160 mm	121.5 mm	5.2 kg	SW 18 mm	180 cm <sup>2</sup> /m	A 15 – C 250	083163

**Slotted steel covers | asymmetrical | material thickness 1.5 mm**

- + Galvanised
- + Also available in stainless steel (V2A)
- + For channel elements NW 100
- + Connection height 102, total height 121.5

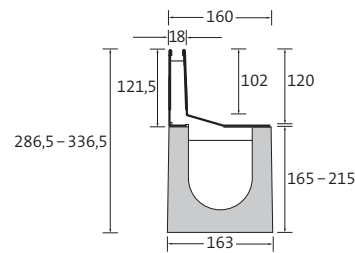

Description	Length	Width	Construction height	Weight	Inlet opening	Inlet cross section	Load class DIN EN 1433	Article no.
galvanised	500 mm	160 mm	121.5 mm	2.7 kg	SW 18 mm	180 cm <sup>2</sup> /m	A 15 – C 250	083180
galvanised	1000 mm	160 mm	121.5 mm	5.5 kg	SW 18 mm	180 cm <sup>2</sup> /m	A 15 – C 250	083169

**Access covers | 2-piece | material thickness 1.5 mm**

- + Galvanised
- + Also available in stainless steel (V2A)
- + For channel elements/outfall units NW 100
- + For total height 121.5
- + With removable insert as maintenance and cleaning opening

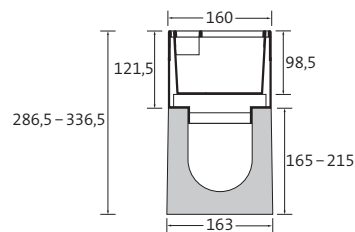

Description	Length	Width	Construction height	Weight	Inlet opening	Inlet cross section	Load class DIN EN 1433	Article no.
without slot	500 mm	160 mm	121.5 mm	6.3 kg	-	-	A 15 – C 250	083157
symmetrical slot	500 mm	160 mm	121.5 mm	6.8 kg	SW 18 mm	180 cm <sup>2</sup> /m	A 15 – C 250	083185
asymmetrical slot	500 mm	160 mm	121.5 mm	5.2 kg	SW 18 mm	180 cm <sup>2</sup> /m	A 15 – C 250	083186

SW = slot width  
Other connection heights on request.



### Channel elements NW 100 for slotted steel covers/access covers | without internal inbuilt fall

- + Covered concrete edge by slotted steel cover/access cover
- + Safety sealing joint
- + Channel elements with internal inbuilt fall upon request

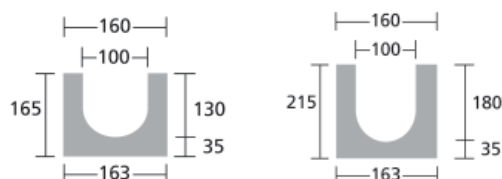

Description	Length	Width	Construction height at groove/tongue	Weight	Load class DIN EN 1433	Article no.
No. 0/0	500 mm	160 mm	165/165 mm	19.0 kg	A 15 – E 600	083331
No. 0/0	1000 mm	160 mm	165/165 mm	37.0 kg	A 15 – E 600	083326
No. 5/0	1000 mm	160 mm	190/190 mm	41.0 kg	A 15 – E 600	083327
No. 10/0	1000 mm	160 mm	215/215 mm	44.0 kg	A 15 – E 600	083328

### Outfall unit NW 100 for access covers | 1-piece

- + 1- or 2-sided channel connection to no. 10/0
- + PP silt bucket
- + PP odour trap
- + Integrated sockets for DN 100 pipe connection

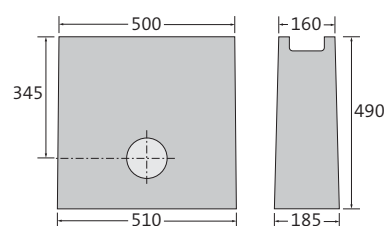

Description	Length	Width at top/ at ground	Construction height	Weight	Load class DIN EN 1433	Article no.
until no. 10	500 mm	160/185 mm	490 mm	57.0 kg	A 15 – E 600	083335

### Lifting device for access covers | Set

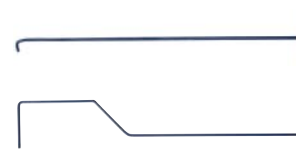

Description	Weight	Article no.
Lifting device for all access covers without slot	0.4 kg	083190
Lifting device for all access covers with slot (symmetrical or asymmetrical)	0.4 kg	083191

### End caps

Description	Width	For construction height	Weight	Article no.
End cap, galvanised, no. 0/0-4	160 mm	155-175 mm	0.3 kg	083195
End cap, galvanised, no. 5-8	160 mm	175-195 mm	0.3 kg	083196
End cap, galvanised, no. 9-12	160 mm	195-215 mm	0.4 kg	083197

